

# UNION TOWNSHIP SECTION 22 R 13 TWP 8 MORGAN COUNTY, OHIO

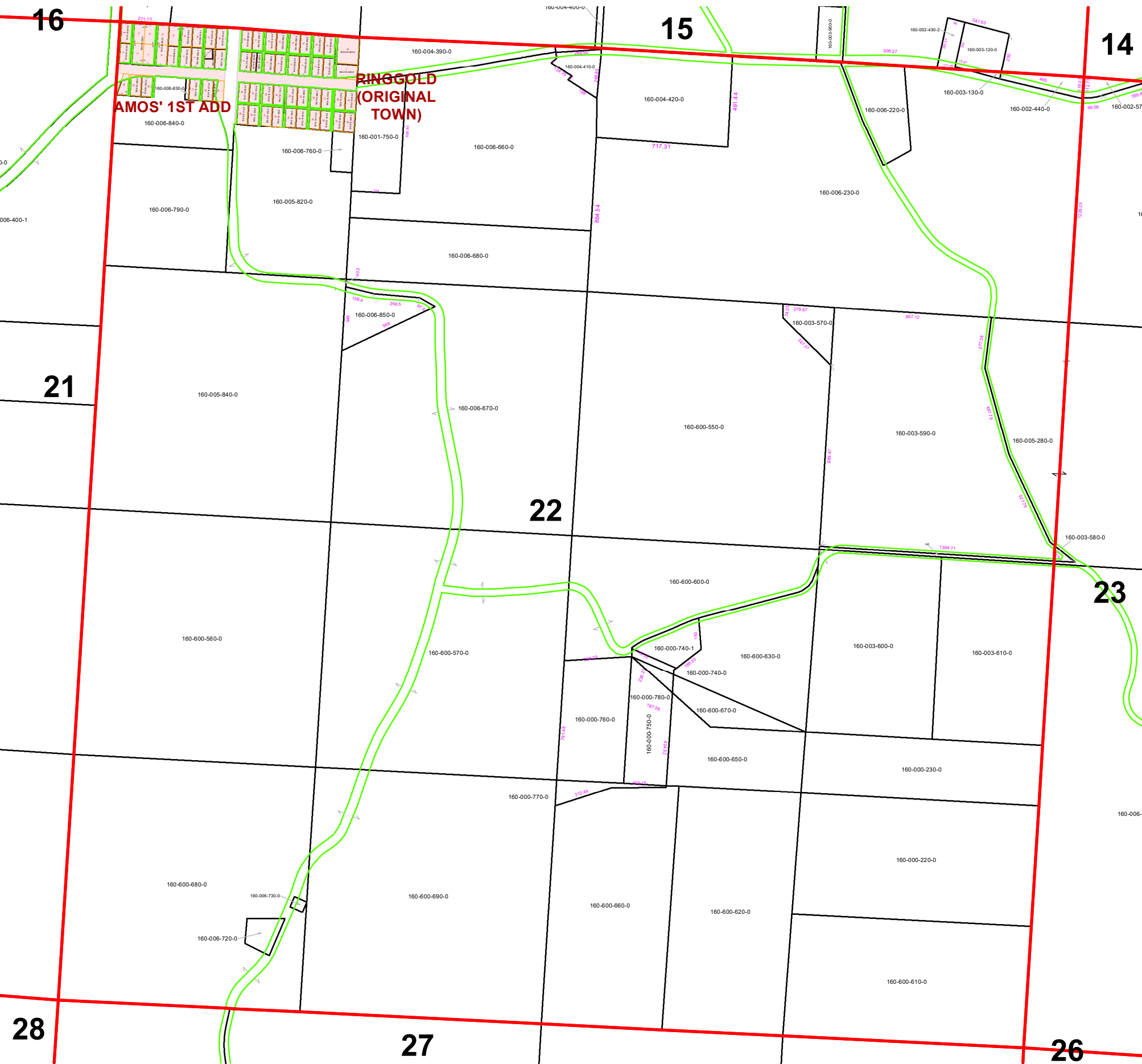

PIN	Owner	LegalDescr	Acres	VOL	PAGE	Survey_Ref
U/I			0			NoSurvey.pdf
160-000-220-0	ANDRUS STANLEY E & SANDRA L	R13 T08 S22 SD 17 N HA	19.75	OR224	1008	NoSurvey.pdf
160-000-230-0	ANDRUS STANLEY E & SANDRA L	R13 T08 S22 SD 27 SUR	10	OR224	1008	NoSurvey.pdf
160-001-750-0	DIAMOND DONALD L	R13 T08 S22 SD 6	3.6	OR21	23	NoSurvey.pdf
160-003-610-0	DIPIETRO SANDRA J & JAMES L LUTHE	R13 T08 S22 SD 31 SUR	14	OR207	1319	NoSurvey.pdf
160-003-600-0	DIPIETRO SANDRA J & JAMES L LUTHE	R13 T08 S22 SD 31 SUR	16	OR207	1319	NoSurvey.pdf
160-003-590-0	DIPIETRO SANDRA J & JAMES L LUTHE	R13 T08 S22 SD 45 SUR	30.095	OR207	1319	UNN-0073.pdf
160-003-570-0	DIPIETRO SANDRA J & JAMES L LUTHE	R13 T08 S22 SD 20 SUR	1.25	OR207	1319	UNN-0073.pdf
160-002-440-0	DRAKE JEFFREY A & ANGELA D	R13 T08 S22 SD 36 SUR	0.775	OR53	567	UNN-0195.pdf
160-003-130-0	KASLER ROGER P & EMERIA I TRUSTE	R13 T08 S22 SD 43	0.08	OR52	536	NoSurvey.pdf
160-000-770-0	LATHEY PAMELA A	R13 T08 S22 SD 37	0.3	OR226	1447	NoSurvey.pdf
160-000-760-0	LATHEY PAMELA A	R13 T08 S22 SD 25	6	OR226	1447	NoSurvey.pdf
160-000-750-0	LATHEY PAMELA A	R13 T08 S22 SD 38	3.27	OR226	1447	NoSurvey.pdf
160-000-780-0	LATHEY PAMELA A	R13 T08 S22 SD 39	0.27	OR226	1447	NoSurvey.pdf
160-000-740-0	LATHEY PAMELA A	R13 T08 S22 SD 40	0.225	OR226	1447	NoSurvey.pdf
160-004-420-0	MCGRATH MOLLIE	R13 T08 S22 SD 35 SUR	7.95	OR234	3909	NoSurvey.pdf
160-004-410-0	MCGRATH MOLLIE	R13 T08 S22 SD 34	0.989	OR234	3909	UNN-0336.pdf
160-006-850-0	MILLIGAN JACOB	R13 T08 S22 SD 44	2.02	OR231	4162	UNN-0003.pdf
160-000-740-1	MOUNT PAUL	R13 T08 S22 SD 46	0.995	OR226	1444	UNN-0335.pdf
160-005-820-0	NICHOLS KEVIN D & KAY L	R13 T08 S22 SD 9 EX 10	14.45	OR224	3369	NoSurvey.pdf
160-004-390-0	NICHOLS VELMA PAULINE TRUST	R13 T08 S22 SD 5-21	5.4			NoSurvey.pdf
160-006-720-0	NOLAND JAMES R	R13 T08 S22 SD 24	0.855	OR107	353	NoSurvey.pdf
160-006-730-0	NOLAND JAMES R	R13 T08 S22 SD 14	0.1	OR107	353	NoSurvey.pdf
160-005-840-0	SHUE RICHARD JR & DIANE IRMA TOD	R13 T08 S22 SD 10 EX C	39	D.V 178	59	NoSurvey.pdf
160-600-610-0	STATE OF OHIO	R13 T08 S22 LOT 17 S H	19.75	D.V 112	153	UNN-0247.pdf
160-600-680-0	STATE OF OHIO	R13 T08 S22 LOT 41	39.145	D.V 113	470	NoSurvey.pdf
160-600-620-0	STATE OF OHIO	R13 T08 S22 LOT 18	20	D.V 112	153	UNN-0247.pdf
160-600-660-0	STATE OF OHIO	R13 T08 S22 LOT 28	19.7	D.V 112	153	UNN-0247.pdf
160-600-690-0	STATE OF OHIO	R13 T08 S22 LOT 42	39.4	D.V 113	470	NoSurvey.pdf
160-600-650-0	STATE OF OHIO	R13 T08 S22 LOT 23	7.17	D.V 112	153	UNN-0247.pdf
160-600-670-0	STATE OF OHIO	R13 T08 S22 LOT 30	1.51	OR186	503	UNN-0247.pdf
160-600-570-0	STATE OF OHIO	R13 T08 S22 LOT 13	40	D.V 113	85	NoSurvey.pdf
160-600-600-0	STATE OF OHIO	R13 T08 S22 LOT 15	13.55			NoSurvey.pdf
160-600-630-0	STATE OF OHIO	R13 T08 S22 LOT 19	8.11	D.V 122	153	UNN-0247.pdf
160-600-560-0	STATE OF OHIO	R13 T08 S22 LOT 12	40	D.V 113	85	NoSurvey.pdf
160-600-550-0	STATE OF OHIO	R13 T08 S22 LOT 3	38.81	D.V 113	85	NoSurvey.pdf
160-006-670-0	STATE OF OHIO DEPT OF NATURAL R	R13 T08 S22 SD 11	36.48	D.V 195	231	NoSurvey.pdf
160-006-680-0	STATE OF OHIO DEPT OF NATURAL R	R13 T08 S22 SD 29	10	D.V 195	231	NoSurvey.pdf
160-006-660-0	STATE OF OHIO DEPT OF NATURAL R	R13 T08 S22 SD 4	19.25	D.V 195	231	NoSurvey.pdf
160-006-230-0	THOMPSON FAMILY TRUST PATRICIA	R13 T08 S22 SD 1	66.15	OR231	4518	NoSurvey.pdf
160-006-220-0	THOMPSON FAMILY TRUST PATRICIA	R13 T08 S22 SD 32	3.1	OR231	4518	NoSurvey.pdf
160-005-280-0	THOMPSON FAMILY TRUST PATRICIA	R13 T08 S22 SD 2	9.405	OR231	4518	NoSurvey.pdf
160-006-760-0	TRENT REBECCA & JIMMIE	R13 T08 S22 SD 33 SUR	0.6	D.V 74	708	NoSurvey.pdf
160-006-790-0	WESTFALL HAROLD E	R13 T08 S22 SD 9 EX AL	10	OR232	1641	NoSurvey.pdf
160-006-840-0	WESTFALL RONNIE L & VICKIE L	R13 T08 S22 SD 8 SURVI	5	D.V 78	1	NoSurvey.pdf

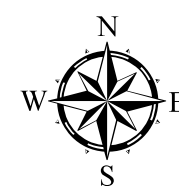

**Boundaries**

- Hydro
- Section
- Roads
- Lot
- County
- Parcel
- ROW
- - - Township



Disclaimer: The information that these maps contains is for reference purposes only. Please bring any erros to the attention of the Engineer's Office staff. Thank you

Source: Morgan County Engineer's Office  
 Author: Marcia Wolfe  
 Date: 02/10/20

